



## The cruise ship:

The new **m/s Kristina Katarina** offers intimate, homely and at the same time high quality cruises in Finnish way. The m/s Kristina Katarina has facilities for about 400 cruise guests and cabins to meet different tastes and needs, beginning from a 9m<sup>2</sup> inside cabin to a 30m<sup>2</sup> high standard ocean view cabin. The ship has a total of 193 cabins and 380 lower beds.

The ship has three dining restaurants: the traditional buffet restaurant, à la carte restaurant serving international classics on the menu and the bistro, where you can drop in for eg. delicious steaks, pizzas and salads. There also are a café near the pool deck, bars and the main restaurant, which is used for evening programs as well as giving lectures and introducing destinations. Brand new saunas built on deck 8 and the pool deck with its three pools is expected to appeal to elder as well as younger cruise guests. The ship has also a shop, where guests may buy gifts and items they might need during the cruise. Cruise guests may treat themselves to a massage or a visit to the hairdresser's, or get fit in the ship's gym.

## Kansi = Deck number

### 4. Kansi

- » Nina -luokka
- » Fanny -luokka
- » Pinta -luokka

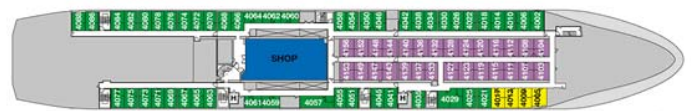

### 5. Kansi

- » Antonia -luokka
- » Cornelia -luokka
- » Pinta -luokka
- » Odysseus -luokka
- » Kolumbus -luokka



### 6. Kansi

- » Buffet ja A`la Carte
- » Promenade bar
- » Uima-allaskansi



### 7. Kansi

- » Odysseus -luokka
- » Kolumbus -luokka
- » Kristina -luokka

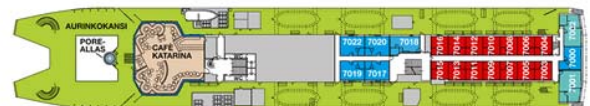

### 8. Kansi

- » Regina -luokka



### 9. Kansi



## Scandinavian Packages AB

Biskop Nils Väg 15. 17676, Järfälla, Sweden

Organization Number: 556710-4889

Innehavare av F-Skattbevis

VAT Number: SE556710488901

Web: [www.scandinavianpackages.com](http://www.scandinavianpackages.com)

Email: [travel@scandinavianpackages.com](mailto:travel@scandinavianpackages.com)

Ph.: +46 (0) 73 6767 284

Ph/ Fax: +46 8 583 53 100



---

### **Cabin Description:**

All cabins have a shower and toilet, a phone for internal calls, radio/music channel and air-conditioning. Electricity 220 V. Elevator between decks 4-6.

### **Cornelia (Included in the standard package)**

2 - 4 berths, inside cabin, shower and toilet.  
Cabin size 11,5 m<sup>2</sup>. Location on deck 5.



---

#### **Scandinavian Packages AB**

Biskop Nils Väg 15. 17676, Järfälla, Sweden

Ph.: +46 (0) 73 6767 284  
Ph/ Fax: +46 8 583 53 100

Organization Number: 556710-4889  
Innehavare av F-Skattbevis  
VAT Number: SE556710488901  
Web: [www.scandinavianpackages.com](http://www.scandinavianpackages.com)  
Email: [travel@scandinavianpackages.com](mailto:travel@scandinavianpackages.com)



**Nina (add 200 Euro per person on the package rate)**

2 - 4 berths, porthole, shower and toilet.

Cabin size 9-10 m<sup>2</sup>. Location on deck 4.



**Antonia (add 400 Euro per person on the package rate)**

2 - 4 berths, window, shower and toilet.

Cabin size 10,5 m<sup>2</sup>. Location on deck 5.



**Scandinavian Packages AB**

Biskop Nils Väg 15. 17676, Järfälla, Sweden

Ph.: +46 (0) 73 6767 284  
Ph/ Fax: +46 8 583 53 100

Organization Number: 556710-4889  
Innehavare av F-Skattbevis  
VAT Number: SE556710488901  
Web: [www.scandinavianpackages.com](http://www.scandinavianpackages.com)  
Email: [travel@scandinavianpackages.com](mailto:travel@scandinavianpackages.com)



---

**Kristina (add 600 Euro per person on the package rate)**

Larger basic cabin with two upper and two lower berths, window to lifeboat deck, shower and toilet. Cabin size 13 m<sup>2</sup>. Location on deck 7.



**Regina (add 800 Euro per person on the package rate)**

Cabin with double bed on highest cabin deck, windows, shower and toilet. Cabin size 14,5 m<sup>2</sup>. Location on deck 8.



**Scandinavian Packages AB**

Biskop Nils Väg 15. 17676, Järfälla, Sweden

Ph.: +46 (0) 73 6767 284  
Ph/ Fax: +46 8 583 53 100

Organization Number: 556710-4889  
Innehavare av F-Skattbevis  
VAT Number: SE556710488901  
Web: [www.scandinavianpackages.com](http://www.scandinavianpackages.com)  
Email: [travel@scandinavianpackages.com](mailto:travel@scandinavianpackages.com)



---

**Odysseus (add 900 Euro per person on the package rate)**

Large cabin with double bed or two lower berths, windows, shower and toilet.  
Cabin size 19 m<sup>2</sup>. Location on deck 5 and 7.



**Kolumbus (add 1100 Euro per person on the package rate)**

Large cabin with separate lounge and sleeping compartment, windows, double bed, sofa corner unit, desk, shower and toilet. Cabin size 25-30 m<sup>2</sup>. Location on deck 5 and 7.



**Scandinavian Packages AB**

Biskop Nils Väg 15. 17676, Järfälla, Sweden

Ph.: +46 (0) 73 6767 284  
Ph/ Fax: +46 8 583 53 100

Organization Number: 556710-4889  
Innehavare av F-Skattbevis  
VAT Number: SE556710488901  
Web: [www.scandinavianpackages.com](http://www.scandinavianpackages.com)  
Email: [travel@scandinavianpackages.com](mailto:travel@scandinavianpackages.com)